

## 2.4.1 Creating Stream Channels

This tutorial covers how to create a channel in Streams. There is also an option to create a Group but this is not recommended.

A group can be comparable to creating a new team on Microsoft Teams, you can add in permission methods. A channel is a way to organize your videos into a common area. We do not recommend creating groups if you are using Teams, creating a channel instead will be more beneficial. It is recommended to view the tutorial **2.7.1 Linking Streams as a Tab in Teams** after this tutorial. For example, you can create a channel called "Lecture Videos" and "Tutorial Videos" to organize content for students and yourself further.

### STEP 1

Navigate to **Create** and select **Channel**

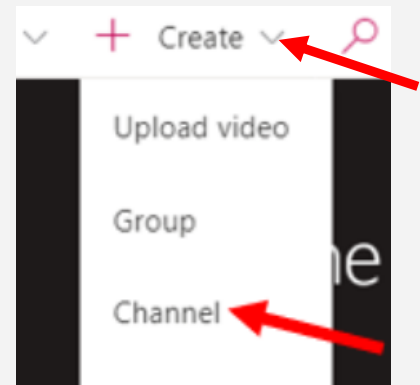

### STEP 2

Fill in the channel information.

Under **Channel access**, select **Group Channel** and search the name of your Team under **Search for your groups** to give only your class team access to your videos.

Otherwise, select **Companywide channel** to give anyone access.

Click **Create** in the bottom right when you're finished filling the information

### STEP 3

To add videos into your channel, navigate to **My Content** then **Videos**. Next to your video, select the icon shown to add to a channel

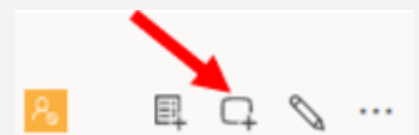

## 2.4.1 Creating Stream Channels

### STEP 4

Click the **Drop Down Arrow** to switch your searching criteria to **Channels**. Search for the channel you just made.

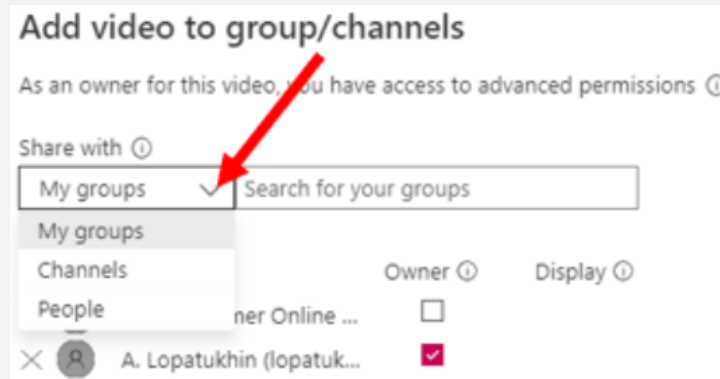

### STEP 5

Set your viewing permissions to **Display** only. Your video will now be in your channel!

